

DN MULTICONTACT is a compact and reliable multipins connector for industrial purposes.

DN MULTICONTACT complies with the essential requirements of the following regulations (a):
European Low Voltage Directive and RoHS (affixing of CE marking), European REACH Regulation, standards IEC/EN 61984, CSA C22.2 N° 182.1 (Canada).

DN MULTICONTACT is certified by the following certification bodies:
CSA (Canada), TR CU (Russia)



DN9C



DN20C

General information

(b) I_n	30 A	25 A
(c) ΣI_n	≤ 210 A	≤ 350 A
U_{max} (V AC/V DC)	415/600	415/600
(d) Frequency (Hz)	≤ 500	≤ 500
(e; f) Number of contacts	9	20
(g) Number of keying positions	2	4
Connection (min - max): mm ²		
Flexible conductors (Cu): main contacts	1 - 6	1 - 6
Rigid/stranded conductors (Cu): main contacts	1.5 - 10	1.5 - 10
Tightening torque - main contacts	0.5 Nm	0.5 Nm
Wiring lugs	Option	Option

Used as connector according to IEC/EN 61984: In

	30 A	25 A
U_{max}	415 V AC	415 V AC
	600 V DC	600 V DC

Number of operations

Mechanical	2 000	2 000
------------	-------	-------

Thermal features

Temperature of use mini/maxi (°C)	-40/+60 °C	-40/+60 °C
Storage temperature mini/max: (°C)	-40/+80 °C	-40/+80 °C
Maximal temperature rise (Kmax)	32 K	60 K

Mechanical features

(h) IP: connected device	IP54	IP54
(h) IP: lid/cap closed	IP55	IP55
(h) IP: socket-outlet with lid/cap opened	IP2X	IP2X
(i) IK	IK09	IK09
Retaining/releasing device	Red release button	
Casing	Aluminium alloy	
	MARECHAL® Blue	
	On request	
Vibrations resistance	✓	✓
Resistance to chemical agents	✓	✓
Protection against UV (according to UL 746C or equivalent)	NA	NA
Salt mist resistance	Contact us	
Screws and bolts	Stainless steel	
Weight of inlet without accessory (≈)	0.6 kg	1.3 kg
Weight of socket-outlet without accessory (≈)	0.4 kg	1.5 kg

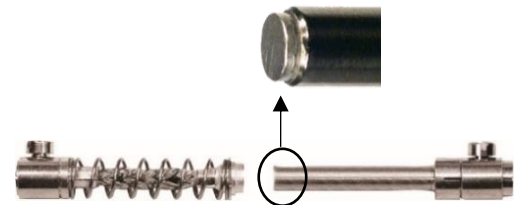

Contacts with silver nickel alloy tips (Ag/Ni : 85/15)

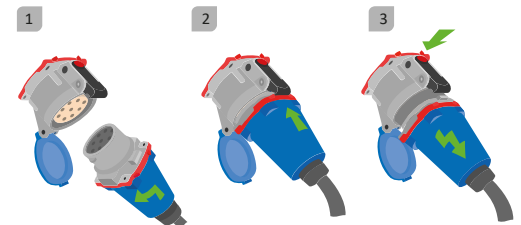

Main options

- Socket-outlet opening up to 180°
- Self-returning lid
- Inlet cap
- Locking / padlocking
- Larger release button ("STOP")
- Operating lever
- Electromagnetic compatibility (EMC)
- IP66/IP67 : inlet or outlet

DN9C

- ✓
- IP40
- IP4X
- ✓
- ✓
- ✓
- ✓
- ✓

DN20C

- ✓
- IP40
- IP4X
- ✓
- ✓
- ✓
- ✓
- ✓

Locking pin for 3 padlocks

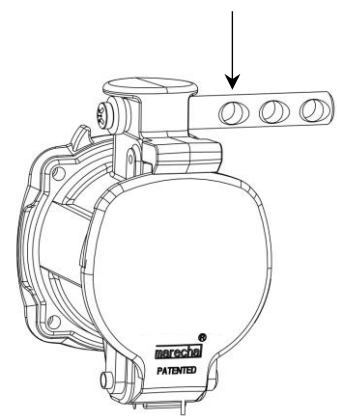

Mounting accessories

- Poly sleeve: angle (°)
- Metal sleeve: angle (°)
- Poly box: angle (°)
- Metal box: angle (°)
- Poly box + poly sleeve: angle (°)
- Metal box + poly sleeve: angle (°)
- Metal box + metal sleeve: angle (°)
- Poly straight handle with built-in cable gland: range take (mm)
- Elastomer straight handle with built-in cable gland: range take (mm)
- Threaded poly straight handle
- Threaded metal straight handle
- Poly straight handle + separated poly cable gland: range take (mm)
- Metal straight handle + separated metal cable gland: range take (mm)

- 30/70
- 0/30/70
- 30
- 20
- 70
- 30
- 0/30/70
- 10 - 30
-
-
-
-
-

- 30
- 0/30/70
-
-
-
- 30
- 0/30/70
-
- 18 - 49
-
-
-
-

- M20 - M40
- M20 - M40

- M50 - M63
- M32 - M63

- 9 - 32
- 7 - 32

- 15 - 48
- 15 - 48

Poly straight handle with built-in cable gland

5 sizes gasket

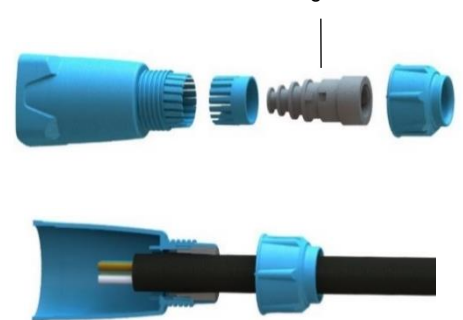

Spare parts

- Inlet or socket-outlet interior moulding
- Inlet or socket-outlet contacts
- Inlet or socket-outlet casing
- Gaskets

- ✓
- ✓
- ✓
- ✓

- ✓
- ✓
- ✓
- ✓

Catalog: [Web link](#)

[Click !](#)

[Click !](#)

Dimensions

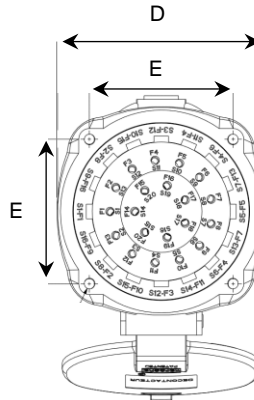
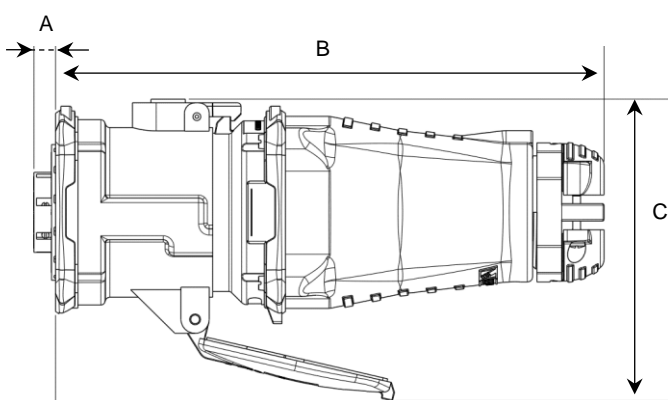

mm	DN9C	DN20C
A	17	12
B	184	311
C	140	173
D	80	118
E	55	81

- (a) European Regulation REACH: registration, evaluation, authorisation and restriction of chemicals
IEC/EN 61984 : "Connectors – Safety requirements and tests"
CSA C22,2 No 182,1-07 : "Plugs, Receptacles, and Cable Connectors of the Pin and Sleeve Type"
- (b) In : Rated current as defined by the manufacturer
- (c) $\Sigma I_n (A)$: sum of current circulating in the contacts
- (d) Other frequency: contact us
- (e) Contacts with silver-nickel tips (Ag/Ni 85/15)
- (f) The contacts can be used either for power or signal
- (g) Number of voltage / frequency / grid, keying positions
- (h) IP : Degrees of protection provided by enclosures (IEC/EN 60529)
- (i) IK : Degrees of protection provided by enclosures against mechanical impacts (IEC/EN 62262)
- (j) Suitable for EMC environments: use of metallic housings and accessories, and cable gland with shielding recovery.